

FULL OVERLAY

Standard Base and Tall Cabinet Depth: 24"

Standard Wall Cabinet Depth: 12"

Veneered Plywood Case: 1/2" Sides, 1/4" Back, 1/2" Bottom

3/4" Thick Face Frame

- Base: 1" or 1 1/2" Stiles, 1 1/2" Rails
- Wall & Tall: 1" or 1 1/2" Stiles, 1 1/2" Bottom Rail, 2" Top Rail

Dovetailed Solid Maple Drawer Box: 5/8" Sides, 1/2" Bottom

Soft Close Doors and Drawers

Adjustable Shelves

All stile and rail widths can be adjusted as necessary

Stile widths may vary per cabinet hinging and location

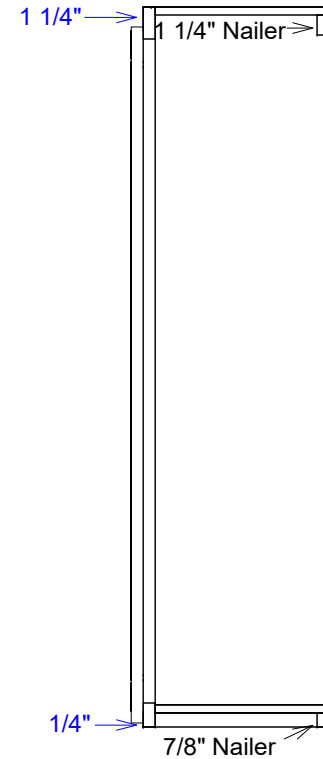

(Openings) (Reveals)

